

BELOW DECK PLAN

PRINCIPAL DIMENSIONS

LENGTH, OVERALL	58' - 6"
LENGTH, WATERLINE	51' - 4"
BEAM, OVERALL	18' - 1"
DRAFT	4' - 4"

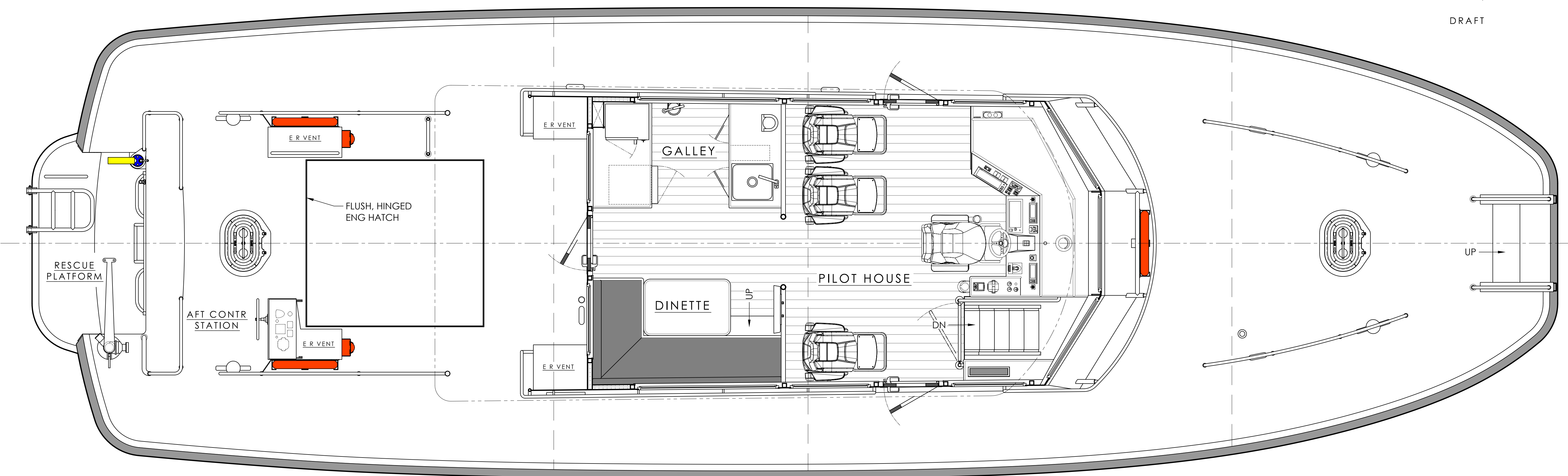

MAIN DECK PLAN

© COPYRIGHT, 2022 C. RAYMOND HUNT ASSOCIATES, INC.
 38 ELM STREET • NEW BEDFORD • MASSACHUSETTS • 02740 • USA
 TEL: 508.717.0600 • FAX: 508.717.0620 • E-MAIL: INFO@RAYHUNTDESIGN.COM

CONFIDENTIAL - C. RAYMOND HUNT ASSOCIATES, INC. retains all rights to copy, use, distribute, display and create derivative works relating to the designs and drawings set forth herein and to make, have made, import, sell, or distribute any watercraft embodying such designs and drawings. These designs and drawings contain information that is proprietary to C. RAYMOND HUNT ASSOCIATES, INC. No use may be made of the designs, drawings or other proprietary information set forth herein without written agreement of C. RAYMOND HUNT ASSOCIATES, INC.

RAY HUNT DESIGN
 DESIGNERS • NAVAL ARCHITECTS

GLADDING-HEARN SHIPBUILDING, DUCLOS CORP
 MARINE ENGINEERS • BUILDERS

PROJECT **56 FT ALUM IPS HARBOR PILOT BOAT**
 VIRGINIA PILOTS ASSOCIATION

DWG TITLE **GENERAL ARRANGEMENT**

SIZE	DESIGN NO.	DRAWING NO.	REV
D	GH-909	- 002	-
DRAWN BY	CHECKED BY		
RPP	WW		
SCALE	ISSUE DATE	SHEET	OF
NTS	OCT 31, 2022	1	1